

**STRUCTURAL ENGINEERING  
BY RIVERMOOR ENGINEERING LLC**

ANY DEVIATION FROM THESE PLANS  
REQUIRING ROCKWOOD DESIGN INC.  
TO ACQUIRE STRUCTURAL REDESIGN FOR  
BUILDING DEPARTMENT SIGN-OFFS WILL BE  
BILLED TO CLIENT ON AN HOURLY BASIS.

SEE SHEET A1 FOR DRAWING INDEX

IF PRINTED ON 11X17, ALL SCALE IS HALF.

PLEASE REFER TO ENGINEERING PACKET  
FOR ALL STRUCTURAL DETAILS

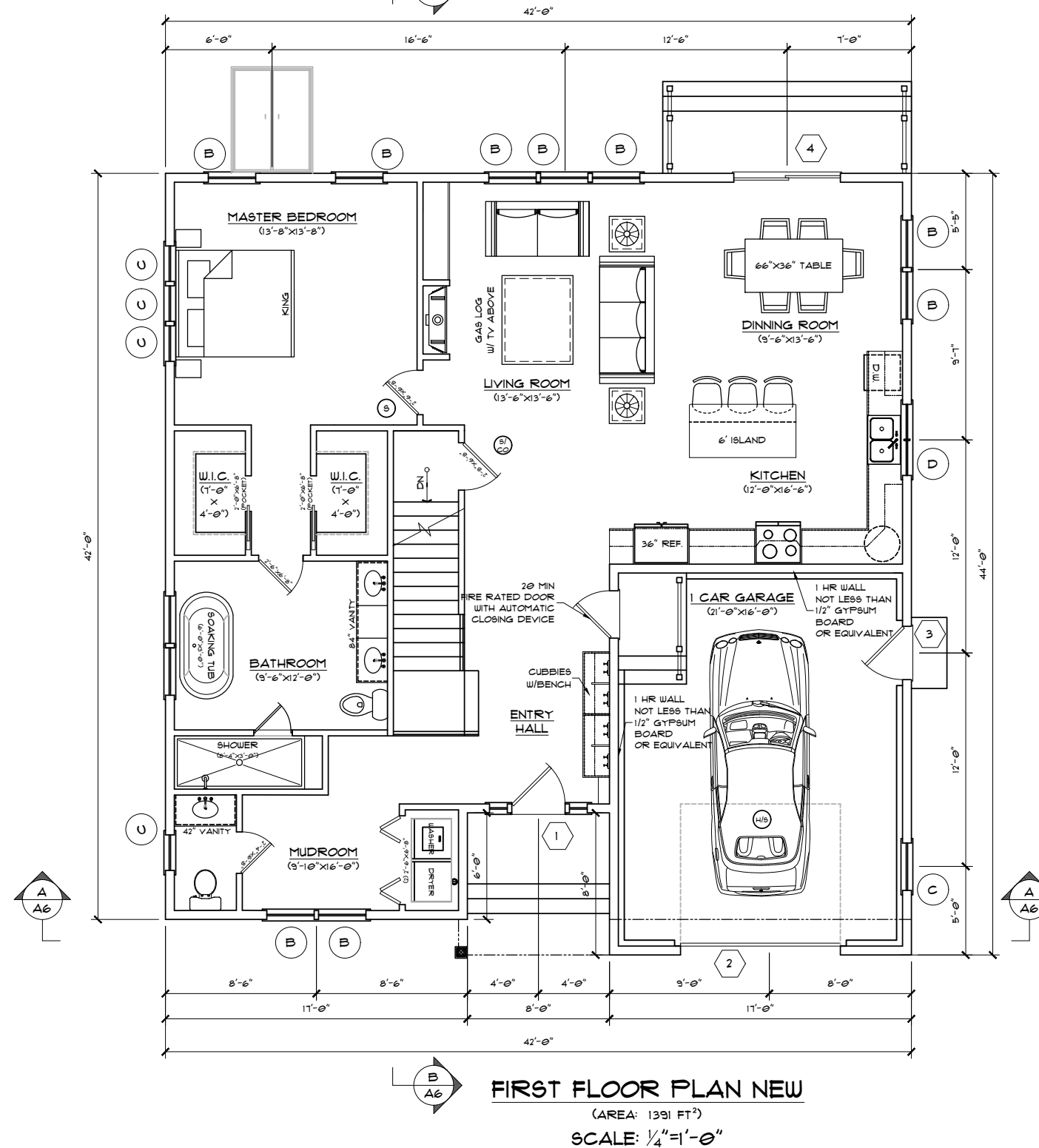

**FIRST FLOOR PLAN NEW**

(AREA: 1391 FT<sup>2</sup>)

SCALE: 1/4" = 1'-0"

REVISION	DATE	DESCRIPTION
1	7-12-23	ADDED FIRE CODE NOTES
2	2-15-24	LAYOUT CHANGE

TITLE  
**PROPOSED FIRST FLOOR PLAN**

PROJECT:  
VILLAGE AT BRICK KILN, LLC  
1 JOSIAH PATH HOUSE F ICG  
FALMOUTH, MA. 02540

**Rockwood Design, Inc.**  
1020 Plain Street - Suite 320  
Marshfield, MA 02050  
Phone: (781)-837-3140  
Email: info@rockwooddesign.com  
Website: www.rockwooddesign.com

DATE: 6/7/2023  
DRAWN BY:  
CHECKED BY:  
SCALE: AS SHOWN

**PERMIT SET - 6/7/2023 REVISED 2-15-24**

**A3**  
OF **A6**

**STRUCTURAL ENGINEERING  
BY RIVERMOOR ENGINEERING LLC**

ANY DEVIATION FROM THESE PLANS  
REQUIRING ROCKWOOD DESIGN INC.  
TO ACQUIRE STRUCTURAL REDESIGN FOR  
BUILDING DEPARTMENT SIGN-OFFS WILL BE  
BILLED TO CLIENT ON AN HOURLY BASIS.

SEE SHEET A1 FOR DRAWING INDEX

IF PRINTED ON 11X17, ALL SCALE IS HALF.

PLEASE REFER TO ENGINEERING PACKET  
FOR ALL STRUCTURAL DETAILS

REVISION	DATE	DESCRIPTION
1	7-12-23	ADDED FIRE CODE NOTES
2	2-15-24	LAYOUT CHANGE

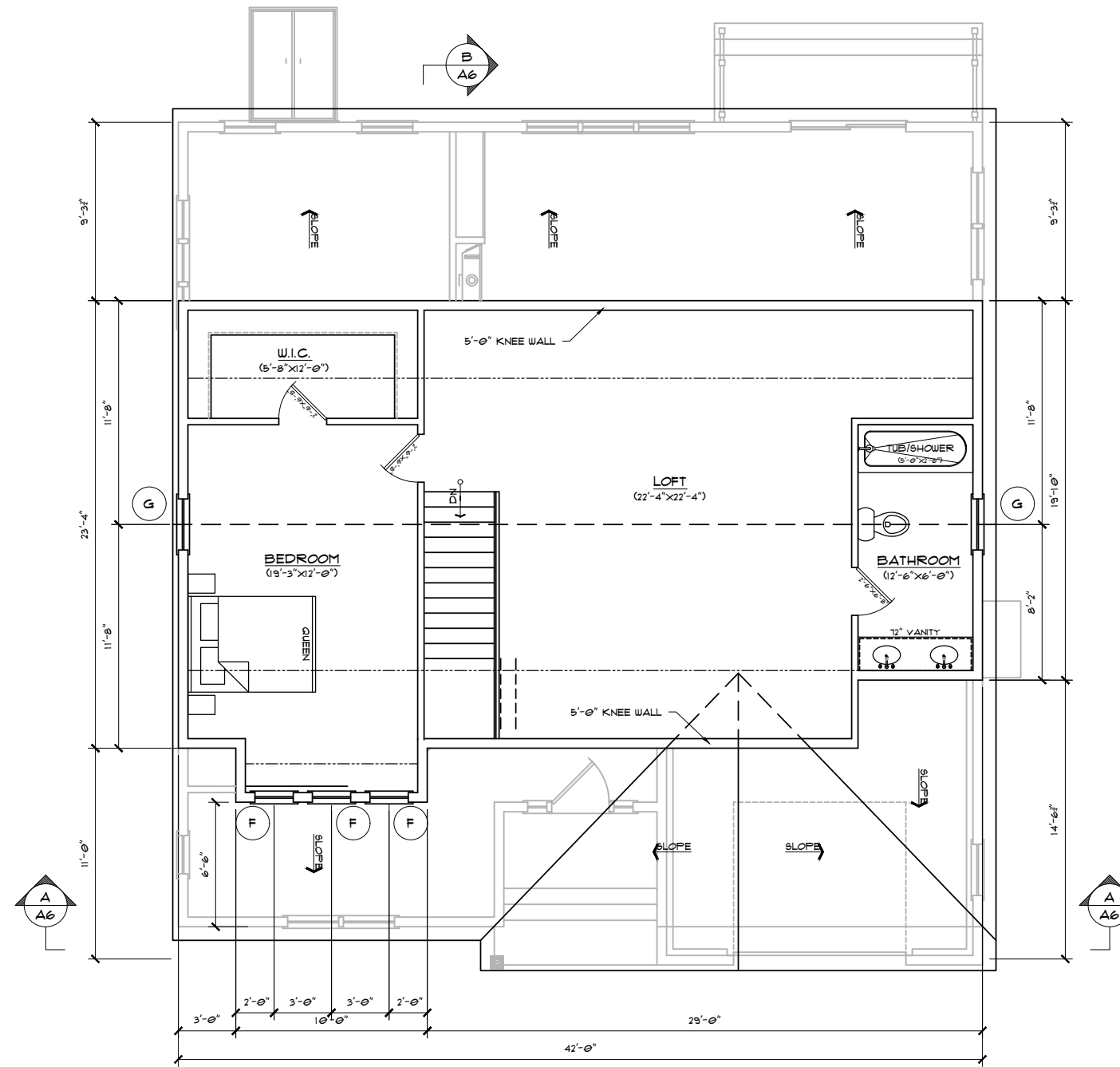

**SECOND FLOOR PLAN NEW**  
(AREA: 1010 FT<sup>2</sup>)  
SCALE: 1/4"=1'-0"

TITLE  
**PROPOSED ATTIC FLOOR PLAN**

PROJECT:  
VILLAGE AT BRICK KILN, LLC  
1 JOSIAH PATH HOUSE F ICG  
FALMOUTH, MA. 02540

**Rockwood Design, Inc.**  
1020 Plain Street - Suite 320  
Marshfield, MA 02050  
Phone: (781)-837-3140  
Fax: (781)-837-3126  
Email: info@rockwooddesign.com  
Website: www.rockwooddesign.com

DATE: 6/1/2023  
DRAWN BY:  
CHECKED BY:  
SCALE: AS SHOWN

**PERMIT SET - 6/1/2023 REVISED 2-15-24**

**A4**  
OF **A6**