

VILLAGE AT BRICK KILN, LLC  
12. JOSIAH PATH. HOUSE 2F  
FALMOUTH, MA. 02540

SEE SHEET A1 FOR DRAWING INDEX

IF PRINTED ON 11X17, ALL SCALE IS HALF.

CONTRACTOR TO VERIFY ALL DIMENSIONS  
AND SETBACKS PRIOR TO CONSTRUCTION

STRUCTURAL ENGINEERING  
BY RIVERMOOR ENGINEERING LLC

**OWNER:**  
VILLAGE AT BRICK KILN, LLC  
12. JOSIAH PATH. HOUSE 2F  
FALMOUTH, MA. 02540  
CELL:  
EMAIL:

**DESIGNER:**  
ROCKWOOD DESIGN, INC.  
1020 PLAIN STREET - SUITE 320  
MARSHFIELD, MA 02050  
PHONE: (781)-837-3140  
FAX: (781)-837-3126  
EMAIL: PHIL@ROCKWOODDESIGN.COM  
WEBSITE: WWW.ROCKWOODDESIGN.COM

**STRUCTURAL  
ENGINEER:**



PERMIT SET - 6/7/2023 REVISED 7-12-23

**Rockwood  
Design, Inc.**  
1020 Plain Street - Suite 320  
Marshfield, MA 02050  
Phone: (781)-837-3140  
Fax: (781)-837-3126  
Email: phil@rockwooddesign.com  
Website: www.rockwooddesign.com

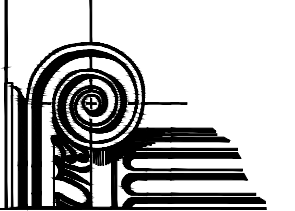

**STRUCTURAL ENGINEERING  
BY RIVERMOOR ENGINEERING LLC**

ANY DEVIATION FROM THESE PLANS  
REQUIRING ROCKWOOD DESIGN INC.  
TO ACQUIRE STRUCTURAL REDESIGN FOR  
BUILDING DEPARTMENT SIGN-OFFS WILL BE  
BILLED TO CLIENT ON AN HOURLY BASIS.

SEE SHEET A1 FOR DRAWING INDEX  
IF PRINTED ON 11X17, ALL SCALE IS HALF.  
PLEASE REFER TO ENGINEERING PACKET  
FOR ALL STRUCTURAL DETAILS

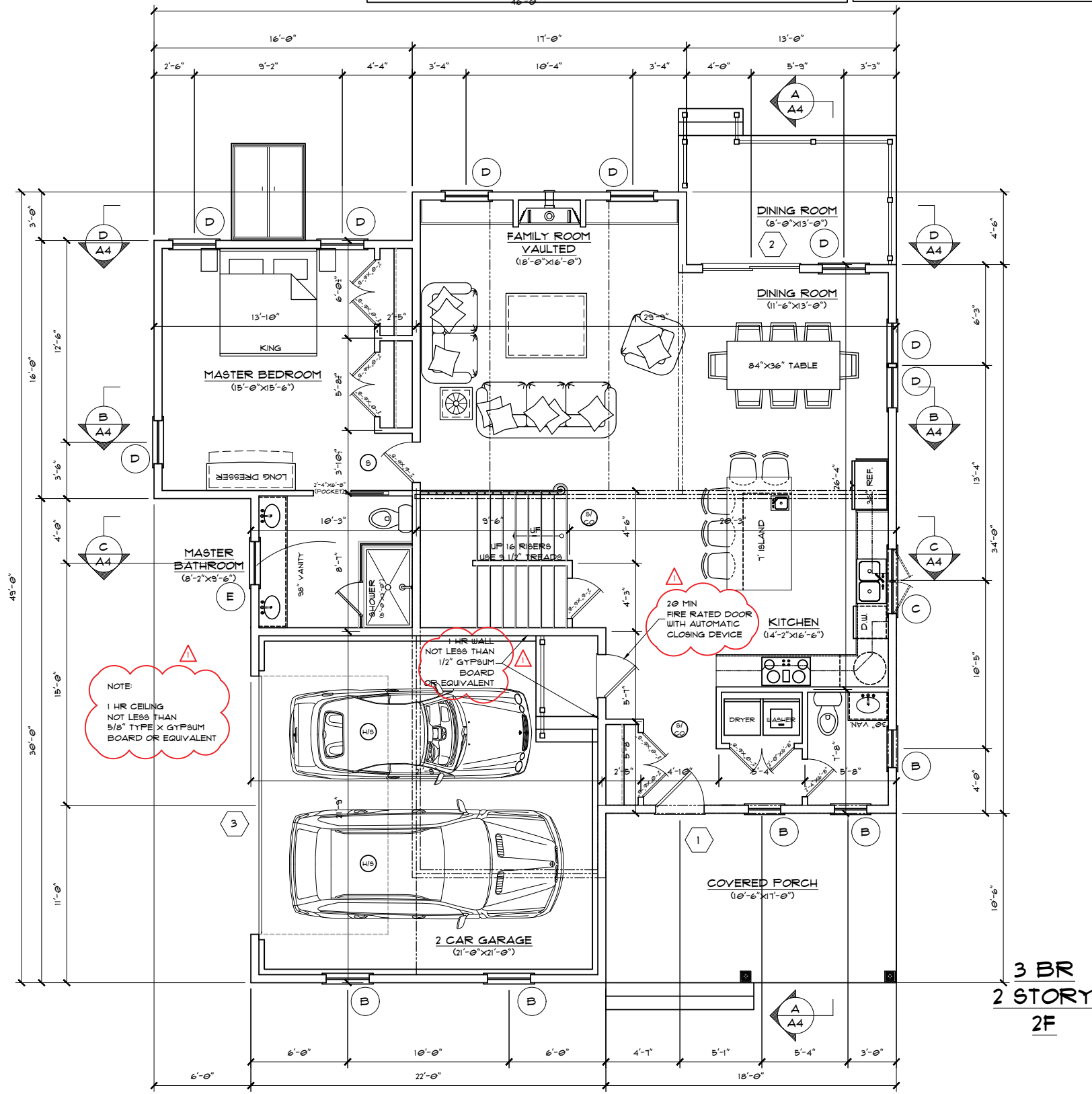

NOTE:  
1 HR CEILING  
NOT LESS THAN  
5/8" TYPE X GYPSUM  
BOARD OR EQUIVALENT

**FIRST FLOOR PLAN**  
(AREA: 1311 FT<sup>2</sup>)  
SCALE: 1/4" = 1'-0"

3 BR  
2 STORY  
2F

REVISION	DATE	DESCRIPTION
1	7-12-23	ADDED FIRE CODE NOTES

TITLE  
PROPOSED FIRST FLOOR PLAN

PROJECT:  
VILLAGE AT BRICK KILN, LLC  
12 JOSIAH PATH, HOUSE 2F  
FALMOUTH MA, 02540

**Rockwood Design, Inc.**  
1020 Plain Street - Suite 320  
Marshfield, MA 02050  
Phone: (781)-837-3140  
Fax: (781)-837-3126  
Email: info@rockwooddesign.com  
Website: www.rockwooddesign.com



DATE: 6/7/2023  
DRAWN BY:  
CHECKED BY:  
SCALE: AS SHOWN

**A3**  
OF **A6**

PERMIT SET - 6/7/2023

**STRUCTURAL ENGINEERING  
BY RIVERMOOR ENGINEERING LLC**

ANY DEVIATION FROM THESE PLANS  
REQUIRING ROCKWOOD DESIGN INC.  
TO ACQUIRE STRUCTURAL REDESIGN FOR  
BUILDING DEPARTMENT SIGN-OFFS WILL BE  
BILLED TO CLIENT ON AN HOURLY BASIS.

SEE SHEET A1 FOR DRAWING INDEX

IF PRINTED ON 11X17, ALL SCALE IS HALF.

PLEASE REFER TO ENGINEERING PACKET  
FOR ALL STRUCTURAL DETAILS

REVISION	DATE	DESCRIPTION
1	7-12-23	ADDED FIRE CODE NOTES

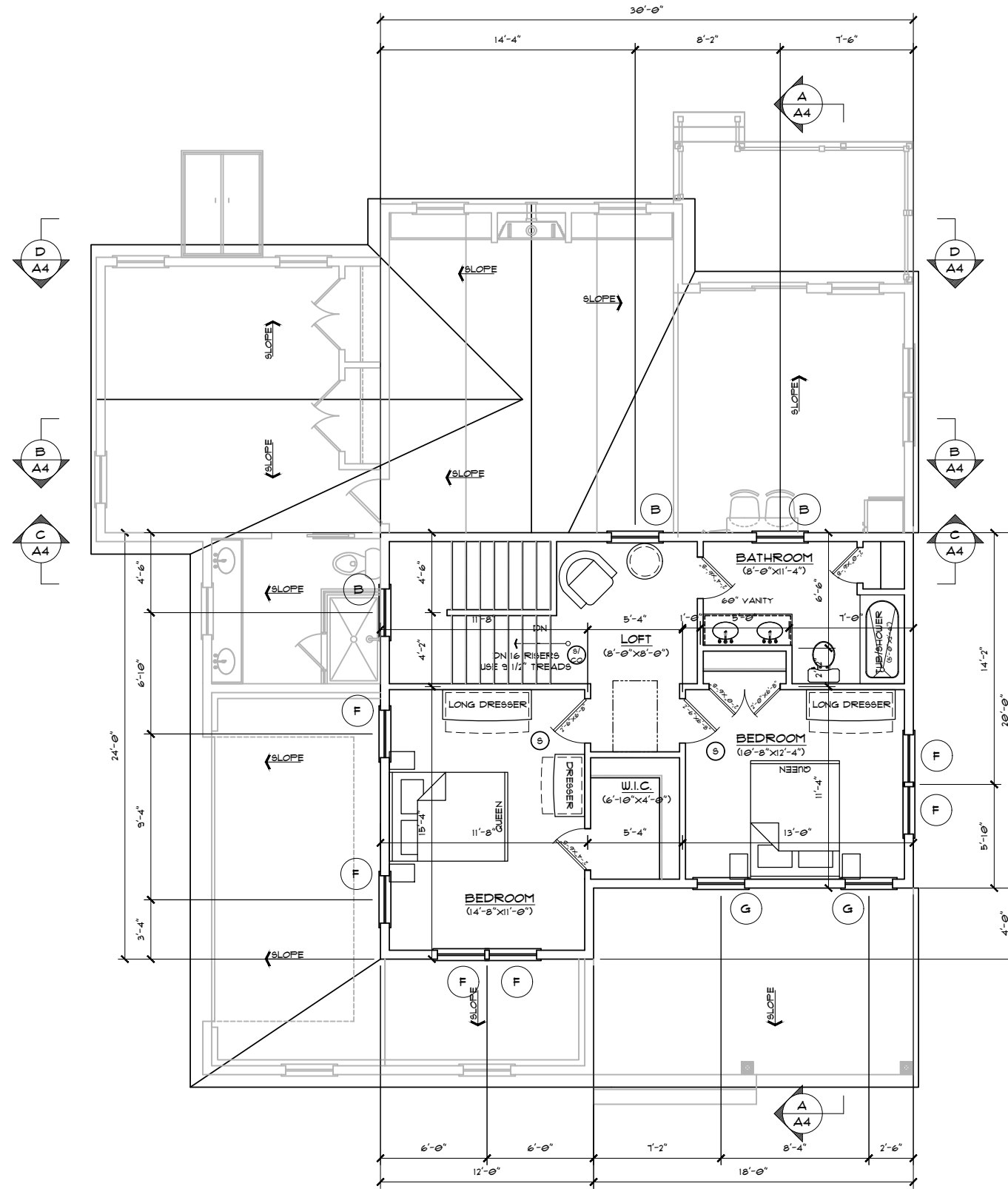

**3 BR  
2 STORY  
2F**

**SECOND FLOOR PLAN**

(AREA: 648 FT<sup>2</sup>)  
SCALE: 1/4" = 1'-0"

**PERMIT SET - 6/7/2023**

PROJECT:  
VILLAGE AT BRICK KILN, LLC  
12 JOSIAH PATH, HOUSE 2F  
FALMOUTH MA, 02540

**Rockwood  
Design, Inc.**  
1020 Plain Street - Suite 320  
Marshfield, MA 02050  
Phone: (781)-837-3140  
Fax: (781)-837-3126  
Email: info@rockwooddesign.com  
Website: www.rockwooddesign.com



DATE: 6/7/2023  
DRAWN BY:  
CHECKED BY:  
SCALE: AS SHOWN

**A4**  
OF A6